

LG EVANS & COMPANY APPLICATION REPORT

Featuring:
Citizen A20vii
At Schlike Music



LG Evans & Company is a full service machine tool dealer, focused on Business Development specializing in bar fed turning solutions, representing Citizen CNC sliding headstock & Miyano fixed headstock machines.

Superlative Quality

Schilke Music of Melrose Park, Illinois, is known for producing world-class trumpets that set the standard for classical and contemporary musicians alike. Since 1956 this family-owned company has been hand-crafting these beautiful instruments, renowned for their rich sound. Trumpet prodigy and company founder Renold O. Schilke combined his musical skills, tool & die experience, and science to create arguably the best sounding trumpets. His pursuit of perfection was just who he was. To this day, Schilke Music still strives for excellence in everything they do, often referring to their trumpets with various superlatives like *"the Mercedes of Trumpets."*

Even in small quantities, many of the small fittings and components for these beautiful works of art are best produced on Swiss-type turning centers. "The parts we were getting from job shops were mediocre and expensive. We needed control over our components' quality, delivery, and cost," says Chris Jones, Schilke's manufacturing manager. "Striving to be the best, we were disappointed in the quality and appearance of parts they provided. We knew we could do better ourselves if we had the right equipment."

A two-year search for the right Swiss-type machine kept leading him back to Citizen, Jones recalls. "We considered several alternatives, but what we saw in machine quality and their sample parts just didn't ring of Schilke quality - it just wasn't up to our standards. Other trusted vendors recommended Citizen as the industry's finest. Internet references likewise pointed to Citizen as

The Citizen A20 CNC Swiss-types enjoy numerous benefits:

- Greater rigidity for faster cuts, longer tool life.
- Better looking parts with finish to 16 μ m.
- Faster rapid and feed rates - higher productivity.
- 5-axis motion control for complex contours.
- Live tooling for drilling and milling operations.
- Gang-style tooling - zero tool change time.
- Synchronous sub-spindle allows machining on all surfaces, even the cut-off back end.
- Ease of adjustment to 0.0001" by programming and tool offsets.

Chris Jones talks quality in superlatives. *"Our trumpets are the industry's finest, just like our Citizen A20 Type VII."*



the industry leader. We watched a number of videos on the Internet and were convinced that Citizen could be the solution we were looking for.

“We were pleased to find that our local sales representative, Jason VanCauwenberge, had a background in music. With his clear explanations of features and options, we quickly gained confidence that we were in good hands with L. G. Evans and Citizen.

“There are endless options in machine configuration and tooling in these types of machines. With Jason’s help, we focused on the capabilities we wanted in a compact, small-footprint machine. The Citizen A20 Type VII provides us the versatility we need. We have ample tool stations to leave many standard tools in the machine and only change a few tools that are specific to individual parts. That helps keep setup times shorter, giving us more flexibility. The back spindle’s X axis provides simultaneous machining capability in both spindles for higher productivity. The A20 type VII delivers a no-compromise solution.”

Schilke Music has many CNC machines, but this was their first CNC Swiss-type machine. “As newcomers to Swiss-type machining, we wanted a company we could count on. The L. G. Evans team of professionals made

startup and our first part a breeze. Their depth and expertise have helped a lot. Once the machine was in place, we were making parts in just hours,” says Jones. “Since startup, L. G. Evans’ support has proven to be both knowledgeable and accessible.”



Precision production parts produced by Schilke Music's A20 Type VII series automatic CNC lathe

Jones sums it up this way; “Quality is timeless. Citizen and Schilke Music share that commitment to excellence.

“It took us a long time to get to the point of buying. You might say that our only regret is that we waited so long. The Citizen A20 type VII helps us make a better product, and will pay for itself in under two years.”

Programming Tech Tip:

Chamfer sharp corners automatically without math, using our Citizen-Cincom ,C function.

Email us at Info@lgevans.com for further information or application assistance.

A20vii

Cincom Evolution Line

Sliding Headstock Type Automatic CNC Lathe



- Citizen's renowned control and ease of use
- 5 axes, 4 rotary tools and subspindle
- X2 axis on the back spindle enabling front/back simultaneous machining
- Highly rigid and reliable
- Non-Guide Bushing Model Also Available –
- The operating convenience you want

4 Rotary Tools for Cross Machining

One Quill type rotary tool position and cross-milling spindle comes with machines as standard.

High Rigidity and Convenient Features

High-rigidity spindles are the key components for precision machining.

User Friendly for Ease of Operation

The pivoting operation panel enables easy operation while simultaneously viewing the machining process.

A Variety of Accessories

Various accessories to enhance your productivity and needs.

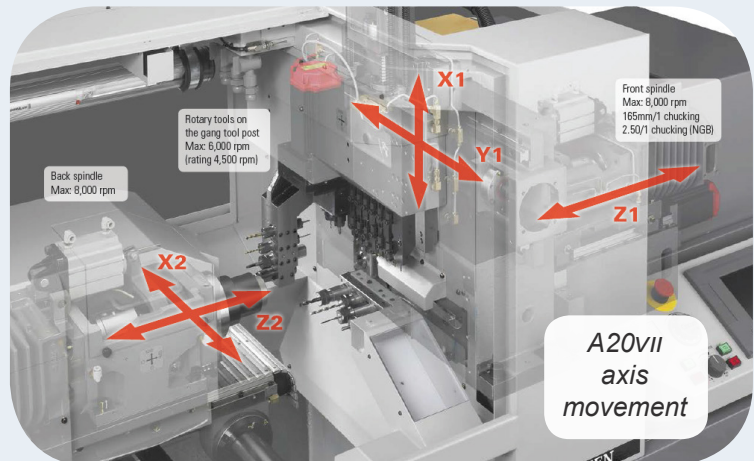

Cross-milling spindle
BSC210

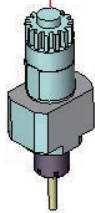

End face
drilling spindle
BSE107

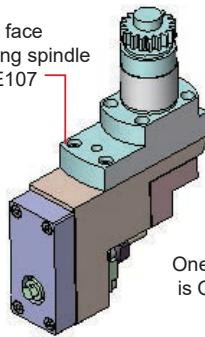

One rotary tool position
is Quill Type

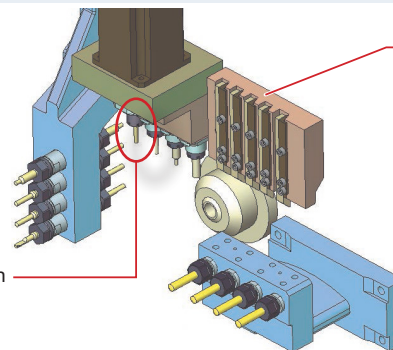

Turning tools on the
gang tool post
5 (1/2" Shank Tool)

Contact us for your precision tooling needs.



L. G. Evans & Company

600 Joliet Road, Suite B Willowbrook, IL 60527 P: (630) 321-1500

2244 Bluemound Road, Suite B2 Waukesha, WI 53186 P: (262) 789-1600

